

CODOS DE 90°

RADIO LARGO CÉDULA STD

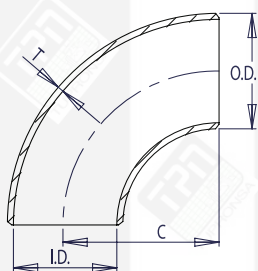

Tamaño del tubo	Diámetro exterior	Diámetro interior	Espesor de la pared	Centro a extremo	Nro. de cédula del tubo	Peso aprox. en kilogramos
NPS	O.D.	I.D.	T	C		
½	21.3	15.76	2.77	38	40	1.27
¾	26.7	20.96	2.87	38	40	1.69
1	33.4	26.64	3.38	38	40	2.50
1 ¼	42.2	35.08	3.56	48	40	3.39
1 ½	48.3	40.94	3.68	57	40	4.05
2	60.3	52.48	3.91	76	40	5.44
2 ½	73.0	62.68	5.16	95	40	8.63
3	88.9	77.92	5.49	114	40	11.29
3 ½	101.6	90.12	5.74	133	40	13.57
4	114.3	102.26	6.02	152	40	16.08
5	141.3	128.20	6.55	190	40	21.77
6	168.3	154.08	7.11	229	40	28.26
8	219.1	202.74	8.18	305	40	42.55
10	273.0	254.46	9.27	381	40	60.29
12	323.8	304.74	9.53	457	*	73.86
14	355.6	336.54	9.53	533	30	81.33
16	406.4	387.34	9.53	610	30	93.27
18	457.0	437.94	9.53	686	*	105.17
20	508.0	488.94	9.53	762	20	117.15
24	610.0	590.94	9.53	914	20	141.12
30	762.0	742.94	9.53	1143	*	176.85
36	914.0	894.94	9.53	1372	*	212.57
42	1067.0	1047.94	9.53	1600	*	248.53
48	1219.0	1199.94	9.53	1829	*	284.25

RADIO LARGO CÉDULA XS

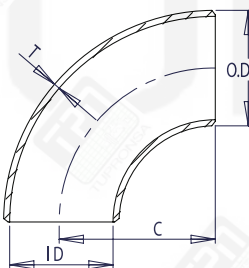

Tamaño del tubo	Diámetro exterior	Diámetro interior	Espesor de la pared	Centro a extremo	Nro. de cédula del tubo	Peso aprox. en kilogramos
NPS	O.D.	I.D.	T	C		
½	21.3	13.84	3.73	38	80.00	1.10
¾	26.7	18.88	3.91	38	80.00	1.62
1	33.4	24.30	4.55	38	80.00	3.24
1 ¼	42.2	32.50	4.85	48	80.00	4.47
1 ½	48.3	38.14	5.08	57	80.00	5.41
2	60.3	49.22	5.54	76	80.00	7.48
2 ½	73.0	58.98	7.01	95	80.00	11.41
3	88.9	73.66	7.62	114	80.00	15.27
3 ½	101.6	85.44	8.08	133	80.00	18.64
4	114.3	97.18	8.56	152	80.00	22.32
5	141.3	122.24	9.53	190	80.00	30.97
6	168.3	146.36	10.97	229	80.00	42.56
8	219.1	193.70	12.70	305	80.00	64.64
10	273.0	247.60	12.70	381	60.00	81.53
12	323.8	298.40	12.70	457	*	97.44
14	355.6	330.20	12.70	533	*	107.40
16	406.4	381.00	12.70	610	40.00	123.31
18	457.0	431.60	12.70	686	*	139.16
20	508.0	482.60	12.70	762	30.00	155.13
24	610.0	584.60	12.70	914	*	187.07
30	762.0	736.60	12.70	1143	20.00	234.68
36	914.0	888.60	12.70	1372	20.00	282.29
42	1067.0	1041.60	12.70	1600	*	330.21
48	1219.0	1193.60	12.70	1829	*	346.18

CODOS DE 90°

RADIO LARGO CÉDULA 40

Tamaño del tubo	Diámetro exterior	Diámetro interior	Espesor de la pared	Centro a extremo	Nro. de cédula del tubo	Peso aprox. en kilogramos
NPS	O.D.	I.D.	T	C		
½	21.3	15.76	2.77	38	40	1.27
¾	26.7	20.96	2.87	38	40	1.69
1	33.4	26.64	3.38	38	40	2.50
1 ¼	42.2	35.08	3.56	48	40	3.39
1 ½	48.3	40.94	3.68	57	40	4.05
2	60.3	52.48	3.91	76	40	5.44
2 ½	73.0	62.68	5.16	95	40	8.63
3	88.9	77.92	5.49	114	40	11.29
3 ½	101.6	90.12	5.74	133	40	13.57
4	114.3	102.26	6.02	152	40	16.08
5	141.3	128.2	6.55	190	40	21.77
6	168.3	154.08	7.11	229	40	28.26
8	219.1	202.74	8.18	305	40	42.55
10	273.0	254.46	9.27	381	40	60.29
12	323.8	303.18	10.31	457	40	79.71
14	355.6	333.34	11.13	533	40	94.55
16	406.4	381.00	12.70	610	40	123.31
18	457.0	428.46	14.27	686	40	155.81
20	508.0	477.82	15.09	762	40	183.43
24	610.0	575.04	17.48	914	40	255.43

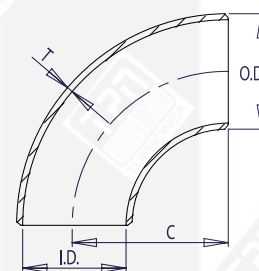

RADIO LARGO CÉDULA 80

Tamaño del tubo	Diámetro exterior	Diámetro interior	Espesor de la pared	Centro a extremo	Nro. de cédula del tubo	Peso aprox. en kilogramos
NPS	O.D.	I.D.	T	C		
½	21.3	15.76	2.77	38	40	1.27
¾	26.7	20.96	2.87	38	40	1.69
1	33.4	26.64	3.38	38	40	2.50
1 ¼	42.2	35.08	3.56	48	40	3.39
1 ½	48.3	40.94	3.68	57	40	4.05
2	60.3	52.48	3.91	76	40	5.44
2 ½	73.0	62.68	5.16	95	40	8.63
3	88.9	77.92	5.49	114	40	11.29
3 ½	101.6	90.12	5.74	133	40	13.57
4	114.3	102.26	6.02	152	40	16.08
5	141.3	128.20	6.55	190	40	21.77
6	168.3	154.08	7.11	229	40	28.26
8	219.1	202.74	8.18	305	40	42.55
10	273.0	254.46	9.27	381	40	60.29
12	323.8	303.18	10.31	457	40	79.71
14	355.6	333.34	11.13	533	40	94.55
16	406.4	381.00	12.70	610	40	123.31
18	457.0	428.46	14.27	686	40	155.81
20	508.0	477.82	15.09	762	40	183.43
24	610.0	575.04	17.48	914	40	255.43

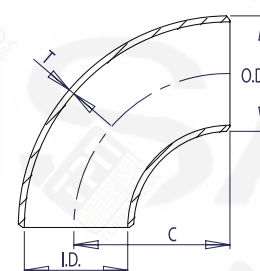

CODOS DE 90°

RADIO LARGO CÉDULA 160

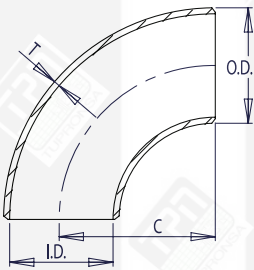

Tamaño del tubo	Diámetro exterior	Diámetro interior	Espesor de la pared	Centro a extremo	Nro. de cédula del tubo	Peso aprox. en kilogramos
NPS	O.D.	I.D.	T	C		
1/2	21.3	11.74	4.78	38	160	1.95
3/4	26.7	15.58	5.56	38	160	2.90
1	33.4	20.7	6.35	38	160	4.24
1 1/4	42.2	29.5	6.35	48	160	5.61
1 1/2	48.3	34.02	7.14	57	160	7.25
2	60.3	42.82	8.74	76	160	11.11
2 1/2	73.0	53.94	9.53	95	160	14.92
3	88.9	66.64	11.13	114	160	21.35
4	114.3	87.32	13.49	152	160	33.54
5	141.3	109.54	15.88	190	160	49.12
6	168.3	131.78	18.26	229	160	67.57
8	219.1	173.08	23.01	305	160	111.27
10	273.0	215.84	28.58	381	160	172.27
12	323.8	257.16	33.32	457	160	238.69
14	355.6	284.18	35.71	533	160	281.72
16	406.4	325.42	40.49	610	160	365.38
18	457.0	366.52	45.24	686	160	459.39
20	508.0	407.98	50.01	762	160	564.85
24	610.0	490.92	59.54	914	160	808.27

RADIO LARGO CÉDULA XXS

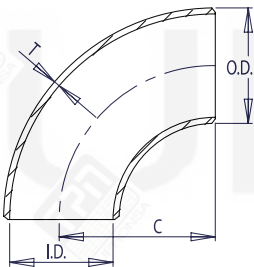

Tamaño del tubo	Diámetro exterior	Diámetro interior	Espesor de la pared	Centro a extremo	Nro. de cédula del tubo	Peso aprox. en kilogramos
NPS	O.D.	I.D.	T	C		
1/2	21.3	6.36	7.47	38	*	2.55
3/4	26.7	11.06	7.82	38	*	3.64
1	33.4	15.22	9.09	38	*	5.45
1 1/4	42.2	22.80	9.70	48	*	7.77
1 1/2	48.3	28.00	10.15	57	*	9.55
2	60.3	38.16	11.07	76	*	13.44
2 1/2	73.0	44.96	14.02	95	*	20.39
3	88.9	58.42	15.24	114	*	27.68
4	114.3	80.06	17.12	152	*	41.03
5	141.3	103.20	19.05	190	*	57.43
6	168.3	124.40	21.95	229	*	79.22
8	219.1	174.64	22.23	305	*	107.93
10	273.0	222.20	25.40	381	140	155.10
12	323.8	273.00	25.40	457	120	186.92

CODOS DE 90°

RADIO CORTO CÉDULA STD

Tamaño del tubo	Diámetro exterior	Diámetro interior	Espesor de la pared	Centro a extremo	Nro. de cédula del tubo	Peso aprox. en kilogramos
NPS	O.D.	I.D.	T	C		
1	33.4	26.64	3.38	25	40	0.14
1 ¼	42.2	35.08	3.56	32	40	0.18
1 ½	48.3	40.94	3.68	38	40	0.23
2	60.3	52.48	3.91	51	40	0.45
2 ½	73.0	62.68	5.16	64	40	0.91
3	88.9	77.92	5.49	76	40	1.36
3 ½	101.6	90.12	5.74	89	40	1.95
4	114.3	102.26	6.02	102	40	2.77
5	141.3	128.20	6.55	127	40	4.40
6	168.3	154.08	7.11	152	40	7.57
8	219.1	202.74	8.18	203	40	14.70
10	273.0	254.46	9.27	254	40	25.54
12	323.8	304.74	9.53	305	*	36.02
14	355.6	336.54	9.53	356	30	47.17
16	406.4	387.34	9.53	406	30	58.51
18	457.0	437.94	9.53	457	*	73.94
20	508.0	488.94	9.53	508	20	95.25
24	610.0	590.94	9.53	610	20	134.72
❖ 30	762.0	742.94	9.53	762	*	213.19
❖ 36	914.0	894.94	9.53	914	*	313.88
❖ 42	1067.0	1047.94	9.53	1067	*	438.62
❖ 48	1219.0	1199.94	9.53	1219	*	607.81

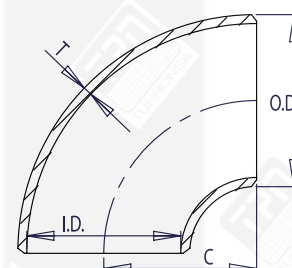

RADIO CORTO CÉDULA XS

Tamaño del tubo	Diámetro exterior	Diámetro interior	Espesor de la pared	Centro a extremo	Nro. de cédula del tubo	Peso aprox. en kilogramos
NPS	O.D.	I.D.	T	C		
1	33.4	24.30	4.55	25	80	0.14
1 ¼	42.2	32.50	4.85	32	80	0.27
1 ½	48.3	38.14	5.08	38	80	0.36
2	60.3	49.22	5.54	51	80	0.68
2 ½	73.0	58.98	7.01	64	80	1.18
3	88.9	73.66	7.62	76	80	1.72
3 ½	101.6	85.44	8.08	89	80	2.45
4	114.3	97.18	8.56	102	80	3.45
5	141.3	122.24	9.53	127	80	6.26
6	168.3	146.36	10.97	152	80	10.34
8	219.1	193.70	12.70	203	80	21.45
10	273.0	247.60	12.70	254	60	32.20
12	323.8	298.40	12.70	305	*	47.17
14	355.6	330.20	12.70	356	*	62.14
16	406.4	381.00	12.70	406	40	77.56
18	457.0	431.60	12.70	457	*	97.07
20	508.0	482.60	12.70	508	30	125.64
24	610.0	584.60	12.70	610	*	176.90
❖ 30	762.0	736.60	12.70	762	20	286.99
❖ 36	914.0	888.60	12.70	914	20	414.13
❖ 42	1067.0	1041.60	12.70	1067	*	589.67
❖ 48	1219.0	1193.60	12.70	1219	*	759.76

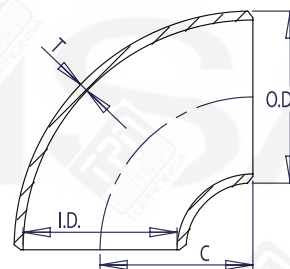

CODOS DE 90°

RADIO CORTO CÉDULA 40

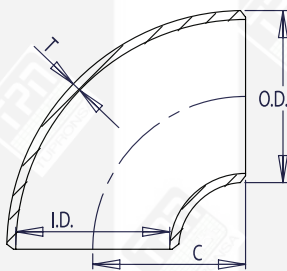

Tamaño del tubo	Diámetro exterior	Diámetro interior	Espesor de la pared	Centro a extremo	Nro. de cédula del tubo	Peso aprox. en kilogramos
NPS	O.D.	I.D.	T	C		
1	33.4	26.64	3.38	25	40	0.14
1 ¼	42.2	35.08	3.56	32	40	0.18
1 ½	48.3	40.94	3.68	38	40	0.23
2	60.3	52.48	3.91	51	40	0.45
2 ½	73.0	62.68	5.16	64	40	0.91
3	88.9	77.92	5.49	76	40	1.36
3 ½	101.6	90.12	5.74	89	40	1.95
4	114.3	102.26	6.02	102	40	2.77
5	141.3	128.20	6.55	127	40	4.40
6	168.3	154.08	7.11	152	40	7.57
8	219.1	202.74	8.18	203	40	14.70
10	273.0	254.46	9.27	254	40	25.54
12	323.8	303.18	10.31	305	40	36.29
14	355.6	333.34	11.13	356	40	47.63
16	406.4	381.00	12.70	406	40	58.97
18	457.0	428.46	14.27	457	40	74.84
20	508.0	477.82	15.09	508	40	97.52
24	610.0	575.04	17.48	610	40	136.08

RADIO CORTO CÉDULA 80

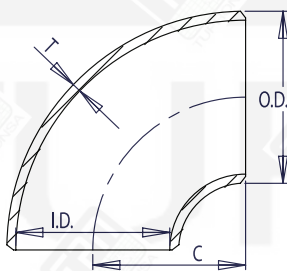

Tamaño del tubo	Diámetro exterior	Diámetro interior	Espesor de la pared	Centro a extremo	Nro. de cédula del tubo	Peso aprox. en kilogramos
NPS	O.D.	I.D.	T	C		
1	33.4	24.30	4.55	25	80	0.14
1 ¼	42.2	32.50	4.85	32	80	0.27
1 ½	48.3	38.14	5.08	38	80	0.36
2	60.3	49.22	5.54	51	80	0.68
2 ½	73.0	58.98	7.01	64	80	1.18
3	88.9	73.66	7.62	76	80	1.72
3 ½	101.6	85.44	8.08	89	80	2.45
4	114.3	97.18	8.56	102	80	3.45
5	141.3	122.24	9.53	127	80	6.26
6	168.3	146.36	10.97	152	80	10.34
8	219.1	193.70	12.70	203	80	21.45
10	273.0	242.82	15.09	254	80	34.02
12	323.8	288.84	17.48	305	80	47.63
14	355.6	317.50	19.05	356	80	63.50
16	406.4	363.52	21.44	406	80	79.38
18	457.0	409.34	23.83	457	80	97.52
20	508.0	455.62	26.19	508	80	127.01
24	610.0	548.08	30.96	610	80	181.44

CODOS DE 90°

RADIO CORTO CÉDULA 160

Tamaño del tubo	Diámetro exterior	Diámetro interior	Espesor de la pared	Centro a extremo	Nro. de cédula del tubo	Peso aprox. en kilogramos
NPS	O.D.	I.D.	T	C		
1	33.4	20.70	6.35	25.40	160	0.23
1 ¼	42.2	29.50	6.35	31.75	160	0.41
1 ½	48.3	34.02	7.14	38.10	160	0.68
2	60.3	42.82	8.74	50.80	160	1.32
2 ½	73.0	53.94	9.53	63.50	160	2.49
3	88.9	66.64	11.13	76.20	160	4.45
4	114.3	87.32	13.49	101.60	160	9.07
5	141.3	109.54	15.88	127.00	160	13.61
6	168.3	131.78	18.26	152.40	160	27.22
8	219.1	173.08	23.01	203.20	160	56.70
10	273.0	215.84	28.58	254.00	160	117.03
12	323.8	257.16	33.32	304.80	160	206.38
14	355.6	284.18	35.71	355.60	160	249.47
16	406.4	325.42	40.49	406.40	160	362.87
18	457.0	366.52	45.24	457.20	160	464.93
20	508.0	407.98	50.01	508.00	160	587.40
24	610.0	490.92	59.54	609.60	160	657.71

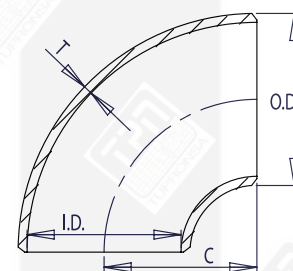

RADIO CORTO CÉDULA XXS

Tamaño del tubo	Diámetro exterior	Diámetro interior	Espesor de la pared	Centro a extremo	Nro. de cédula del tubo	Peso aprox. en kilogramos
NPS	O.D.	I.D.	T	C		
1	33.4	15.22	9.09	25.40	*	0.29
1 ¼	42.2	22.80	9.70	31.75	*	0.59
1 ½	48.3	28.00	10.15	38.10	*	0.77
2	60.3	38.16	11.07	50.80	*	1.45
2 ½	73.0	44.96	14.02	63.50	*	2.77
3	88.9	58.42	15.24	76.20	*	4.99
4	114.3	80.06	17.12	101.60	*	9.98
5	141.3	103.20	19.05	127.00	*	15.88
6	168.3	124.40	21.95	152.40	*	27.22
8	219.1	174.64	22.23	203.20	*	55.79
10	273.0	222.20	25.40	254.00	140	102.06
12	323.8	273.00	25.40	304.80	120	165.56

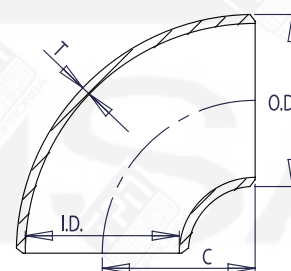

CODOS DE 90°

3R CÉDULA STD

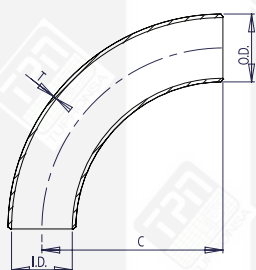

Tamaño del tubo NPS	Diámetro exterior O.D.	Diámetro interior I.D.	Espesor de la pared T	Centro a extremo C	Nro. de cédula del tubo	Peso aprox. en kilogramos
3/4	26.7	20.96	2.87	57	40	0.14
1	33.4	26.64	3.38	76	40	0.36
1 1/4	42.2	35.08	3.56	95	40	0.50
1 1/2	48.3	40.94	3.68	114	40	0.73
2	60.3	52.48	3.91	152	40	1.45
2 1/2	73.0	62.68	5.16	190	40	2.90
3	88.9	77.92	5.49	229	40	4.35
3 1/2	101.6	90.12	5.74	267	40	6.80
4	114.3	102.26	6.02	305	40	8.07
5	141.3	128.20	6.55	381	40	13.61
6	168.3	154.08	7.11	457	40	21.77
8	219.1	202.74	8.18	610	40	43.09
10	273.0	254.46	9.27	762	40	75.75
12	323.8	304.74	9.53	914	*	113.40
14	355.6	336.54	9.53	1067	30	140.61
16	406.4	387.34	9.53	1219	30	188.24
18	457.0	437.94	9.53	1372	*	240.40
20	508.0	488.94	9.53	1524	20	294.83
24	610.0	590.94	9.53	1829	20	424.11

3R CÉDULA XS

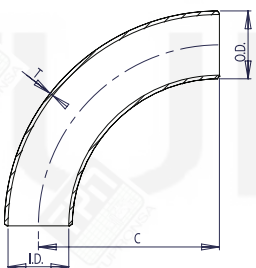

Tamaño del tubo NPS	Diámetro exterior O.D.	Diámetro interior I.D.	Espesor de la pared T	Centro a extremo C	Nro. de cédula del tubo	Peso aprox. en kilogramos
3/4	26.7	18.88	3.91	57	80	0.14
1	33.4	24.30	4.55	76	80	0.72
1 1/4	42.2	32.50	4.85	95	80	1.09
1 1/2	48.3	38.14	5.08	114	80	1.91
2	60.3	49.22	5.54	152	80	3.45
2 1/2	73.0	58.98	7.01	190	80	5.72
3	88.9	73.66	7.62	229	80	7.80
3 1/2	101.6	85.44	8.08	267	80	9.98
4	114.3	97.18	8.56	305	80	11.34
5	141.3	122.24	9.53	381	80	20.41
6	168.3	146.36	10.97	457	80	31.75
8	219.1	193.70	12.70	610	80	65.77
10	273.0	247.60	12.70	762	60	102.06
12	323.8	298.40	12.70	914	*	145.15
14	355.6	330.20	12.70	1067	*	183.70
16	406.4	381.00	12.70	1219	40	244.94
18	457.0	431.60	12.70	1372	*	317.51
20	508.0	482.60	12.70	1524	30	383.28
24	610.0	584.60	12.70	1829	*	548.84

CODOS DE 90°

Tamaño del tubo	Diámetro exterior	Diámetro interior	Espesor de la pared	Centro a extremo	Nro. de cédula del tubo	Peso aprox. en kilogramos
NPS	O.D.	I.D.	T	C		
¾	26.7	20.96	2.87	57	40	0.14
1	33.4	26.64	3.38	76	40	0.36
1 ¼	42.2	35.08	3.56	95	40	0.50
1 ½	48.3	40.94	3.68	114	40	0.73
2	60.3	52.48	3.91	152	40	1.45
2 ½	73.0	62.68	5.16	190	40	2.90
3	88.9	77.92	5.49	229	40	4.35
3 ½	101.6	90.12	5.74	267	40	6.80
4	114.3	102.26	6.02	305	40	8.07
5	141.3	128.20	6.55	381	40	13.61
6	168.3	154.08	7.11	457	40	21.77
8	219.1	202.74	8.18	610	40	43.09
10	273.0	254.46	9.27	762	40	75.75
12	323.8	303.18	10.31	914	40	92.99
14	355.6	333.34	11.13	1067	40	138.34
16	406.4	381.00	12.70	1219	40	244.94
18	457.0	428.46	14.27	1372	40	335.66
20	508.0	477.82	15.09	1524	40	430.91
24	610.0	575.04	17.48	1829	40	635.03

3R CÉDULA 40

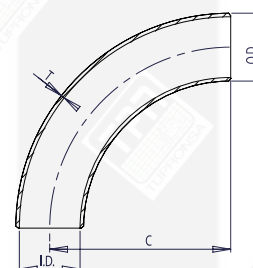

Tamaño del tubo	Diámetro exterior	Diámetro interior	Espesor de la pared	Centro a extremo	Nro. de cédula del tubo	Peso aprox. en kilogramos
NPS	O.D.	I.D.	T	C		
¾	26.7	18.88	3.91	57	80	0.14
1	33.4	24.30	4.55	76	80	0.72
1 ¼	42.2	32.50	4.85	95	80	1.09
1 ½	48.3	38.14	5.08	114	80	1.91
2	60.3	49.22	5.54	152	80	3.45
2 ½	73.0	58.98	7.01	190	80	5.72
3	88.9	73.66	7.62	229	80	7.80
3 ½	101.6	85.44	8.08	267	80	9.98
4	114.3	97.18	8.56	305	80	11.34
5	141.3	122.24	9.53	381	80	20.41
6	168.3	146.36	10.97	457	80	31.75
8	219.1	193.70	12.70	610	80	65.77
10	273.0	242.82	15.09	762	80	90.72
12	323.8	288.84	17.48	914	80	145.15
14	355.6	317.50	19.05	1067	80	272.15
16	406.4	363.52	21.44	1219	80	367.41
18	457.0	409.34	23.83	1372	80	462.66
20	508.0	455.62	26.19	1524	80	635.03
24	610.0	548.08	30.96	1829	80	816.46

3R CÉDULA 80

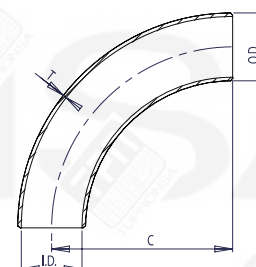

CODOS DE 45°

CÉDULA STD

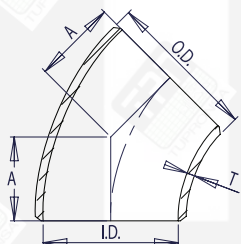

Tamaño del tubo	Diámetro exterior	Diámetro interior	Espesor de la pared	Centro a extremo	Nro. de cédula del tubo	Peso aprox. en kilogramos
NPS	O.D.	I.D.	T	A		
1/2	21.3	15.76	2.77	16	40	0.04
3/4	26.7	20.96	2.87	19	40	0.05
1	33.4	26.64	3.38	22	40	0.10
1 1/4	42.2	35.08	3.56	25	40	0.15
1 1/2	48.3	40.94	3.68	29	40	0.20
2	60.3	52.48	3.91	35	40	0.39
2 1/2	73.0	62.68	5.16	44	40	0.77
3	88.9	77.92	5.49	51	40	1.13
3 1/2	101.6	90.12	5.74	57	40	1.54
4	114.3	102.26	6.02	64	40	2.04
5	141.3	128.20	6.55	79	40	3.40
6	168.3	154.08	7.11	95	40	5.31
8	219.1	202.74	8.18	127	40	10.57
10	273.0	254.46	9.27	159	40	18.55
12	323.8	304.74	9.53	190	*	27.85
14	355.6	336.54	9.53	222	30	35.43
16	406.4	387.34	9.53	254	30	45.81
18	457.0	437.94	9.53	286	*	58.06
20	508.0	488.94	9.53	318	20	72.12
24	610.0	590.94	9.53	381	20	104.78
30	762.0	742.94	9.53	470	*	162.39
36	914.0	894.94	9.53	565	*	234.96
42	1067.0	1047.94	9.53	660	*	320.69
48	1219.0	1199.94	9.53	759	*	453.59

CÉDULA XS

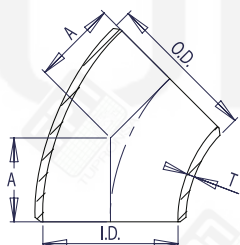

Tamaño del tubo	Diámetro exterior	Diámetro interior	Espesor de la pared	Centro a extremo	Nro. de cédula del tubo	Peso aprox. en kilogramos
NPS	O.D.	I.D.	T	A		
1/2	21.3	13.84	3.73	16	80	0.07
3/4	26.7	18.88	3.91	19	80	0.07
1	33.4	24.30	4.55	22	80	0.13
1 1/4	42.2	32.50	4.85	25	80	0.20
1 1/2	48.3	38.14	5.08	29	80	0.28
2	60.3	49.22	5.54	35	80	0.54
2 1/2	73.0	58.98	7.01	44	80	0.91
3	88.9	73.66	7.62	51	80	1.50
3 1/2	101.6	85.44	8.08	57	80	2.04
4	114.3	97.18	8.56	64	80	2.81
5	141.3	122.24	9.53	79	80	4.76
6	168.3	146.36	10.97	95	80	7.71
8	219.1	193.70	12.70	127	80	15.56
10	273.0	247.60	12.70	159	60	24.27
12	323.8	298.40	12.70	190	*	35.20
14	355.6	330.20	12.70	222	*	45.36
16	406.4	381.00	12.70	254	40	60.78
18	457.0	431.60	12.70	286	*	77.11
20	508.0	482.60	12.70	318	30	94.80
24	610.0	584.60	12.70	381	*	136.98
30	762.0	736.60	12.70	470	20	215.50
36	914.0	888.60	12.70	565	20	311.21
42	1067.0	1041.60	12.70	660	*	424.61
48	1219.0	1193.60	12.70	759	*	566.99

CODOS DE 45°

CÉDULA 40

Tamaño del tubo	Diámetro exterior	Diámetro interior	Espesor de la pared	Centro a extremo	Nro. de cédula del tubo	Peso aprox. en kilogramos
NPS	O.D.	I.D.	T	A		
½	21.3	15.76	2.77	16	40	0.04
¾	26.7	20.96	2.87	19	40	0.05
1	33.4	26.64	3.38	22	40	0.10
1 ¼	42.2	35.08	3.56	25	40	0.15
1 ½	48.3	40.94	3.68	29	40	0.20
2	60.3	52.48	3.91	35	40	0.39
2 ½	73.0	62.68	5.16	44	40	0.77
3	88.9	77.92	5.49	51	40	1.13
3 ½	101.6	90.12	5.74	57	40	1.54
4	114.3	102.26	6.02	64	40	2.04
5	141.3	128.20	6.55	79	40	3.40
6	168.3	154.08	7.11	95	40	5.31
8	219.1	202.74	8.18	127	40	10.57
10	273.0	254.46	9.27	159	40	18.55
12	323.8	303.18	10.31	190	40	29.48
14	355.6	333.34	11.13	222	40	36.29
16	406.4	381.00	12.70	254	40	47.63
18	457.0	428.46	14.27	286	40	58.97
20	508.0	477.82	15.09	318	40	74.84
24	610.0	575.04	17.48	381	40	106.59

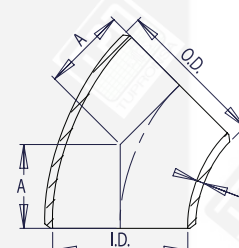

Tamaño del tubo	Diámetro exterior	Diámetro interior	Espesor de la pared	Centro a extremo	Nro. de cédula del tubo	Peso aprox. en kilogramos
NPS	O.D.	I.D.	T	A		
½	21.3	13.84	3.73	16	80	0.07
¾	26.7	18.88	3.91	19	80	0.07
1	33.4	24.30	4.55	22	80	0.13
1 ¼	42.2	32.50	4.85	25	80	0.20
1 ½	48.3	38.14	5.08	29	80	0.28
2	60.3	49.22	5.54	35	80	0.54
2 ½	73.0	58.98	7.01	44	80	0.91
3	88.9	73.66	7.62	51	80	1.50
3 ½	101.6	85.44	8.08	57	80	2.04
4	114.3	97.18	8.56	64	80	2.81
5	141.3	122.24	9.53	79	80	4.76
6	168.3	146.36	10.97	95	80	7.71
8	219.1	193.70	12.70	127	80	15.56
10	273.0	242.82	15.09	159	80	24.95
12	323.8	288.84	17.48	190	80	36.29
14	355.6	317.50	19.05	222	80	45.36
16	406.4	363.52	21.44	254	80	61.23
18	457.0	409.34	23.83	286	80	79.38
20	508.0	455.62	26.19	318	80	95.25
24	610.0	548.08	30.96	381	80	138.34

CÉDULA 80

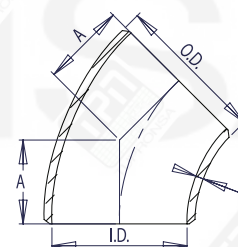

CODOS DE 45°

CÉDULA 160

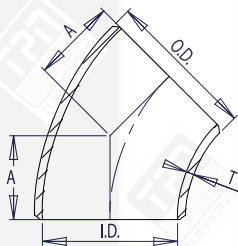

Tamaño del tubo	Diámetro exterior	Diámetro interior	Espesor de la pared	Centro a extremo	Nro. de cédula del tubo	Peso aprox. en kilogramos
NPS	O.D.	I.D.	T	A		
1/2	21.3	11.74	4.78	16	160	0.82
3/4	26.7	15.58	5.56	19	160	0.91
1	33.4	20.70	6.35	22	160	1.36
1 1/4	42.2	29.50	6.35	25	160	1.59
1 1/2	48.3	34.02	7.14	29	160	1.68
2	60.3	42.82	8.74	35	160	2.27
2 1/2	73.0	53.94	9.53	44	160	1.68
3	88.9	66.64	11.13	51	160	2.54
4	114.3	87.32	13.49	64	160	2.54
5	141.3	109.54	15.88	79	160	6.80
6	168.3	131.78	18.26	95	160	12.70
8	219.1	173.08	23.01	127	160	21.77
10	273.0	215.84	28.58	159	160	32.66
12	323.8	257.16	33.32	190	160	44.45
14	355.6	284.18	35.71	222	160	58.97
16	406.4	325.42	40.49	254	160	81.65
18	457.0	366.52	45.24	286	160	117.93
20	508.0	407.98	50.01	318	160	176.90
24	610.0	490.92	59.54	381	160	254.01

CÉDULA XXS

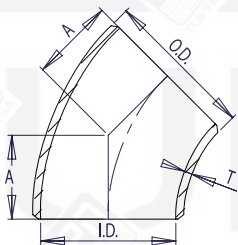

Tamaño del tubo	Diámetro exterior	Diámetro interior	Espesor de la pared	Centro a extremo	Nro. de cédula del tubo	Peso aprox. en kilogramos
NPS	O.D.	I.D.	T	A		
1/2	21.3	6.36	7.47	16	*	0.82
3/4	26.7	11.06	7.82	19	*	0.91
1	33.4	15.22	9.09	22	*	1.36
1 1/4	42.2	22.80	9.70	25	*	1.59
1 1/2	48.3	28.00	10.15	29	*	1.68
2	60.3	38.16	11.07	35	*	2.27
2 1/2	73.0	44.96	14.02	44	*	1.68
3	88.9	58.42	15.24	51	*	2.72
4	114.3	80.06	17.12	64	*	4.72
5	141.3	103.20	19.05	79	*	8.71
6	168.3	124.40	21.95	95	*	13.61
8	219.1	174.64	22.23	127	*	22.68
10	273.0	222.20	25.40	159	140	34.02
12	323.8	273.00	25.40	190	120	43.09

3R

CÉDULA STD

Tamaño del tubo	Diámetro exterior	Diámetro interior	Espesor de la pared	Centro a extremo	Nro. de cédula del tubo	Peso aprox. en kilogramos
NPS	O.D.	I.D.	T	A		
¾	26.7	20.96	2.87	24	40	0.23
1	33.4	26.64	3.38	31	40	0.32
1 ¼	42.2	35.08	3.56	39	40	0.45
1 ½	48.3	40.94	3.68	47	40	0.59
2	60.3	52.48	3.91	63	40	0.68
2 ½	73.0	62.68	5.16	79	40	0.79
3	88.9	77.92	5.49	95	40	1.36
3 ½	101.6	90.12	5.74	111	40	2.27
4	114.3	102.26	6.02	127	40	4.08
5	141.3	128.20	6.55	157	40	7.26
6	168.3	154.08	7.11	189	40	10.21
8	219.1	202.74	8.18	252	40	20.41
10	273.0	254.46	9.27	316	40	36.29
12	323.8	304.74	9.53	378	*	54.43
14	355.6	336.54	9.53	441	30	68.04
16	406.4	387.34	9.53	505	30	87.54
18	457.0	437.94	9.53	568	*	112.49
20	508.0	488.94	9.53	632	20	139.71
24	610.0	590.94	9.53	757	20	199.58

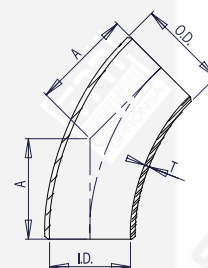

3R

CÉDULA XS

Tamaño del tubo	Diámetro exterior	Diámetro interior	Espesor de la pared	Centro a extremo	Nro. de cédula del tubo	Peso aprox. en kilogramos
NPS	O.D.	I.D.	T	A		
¾	26.7	18.88	3.91	24	80	0.07
1	33.4	24.30	4.55	31	80	0.13
1 ¼	42.2	32.50	4.85	39	80	0.20
1 ½	48.3	38.14	5.08	47	80	0.28
2	60.3	49.22	5.54	63	80	0.54
2 ½	73.0	58.98	7.01	79	80	0.91
3	88.9	73.66	7.62	95	80	1.50
3 ½	101.6	85.44	8.08	111	80	2.04
4	114.3	97.18	8.56	127	80	2.81
5	141.3	122.24	9.53	157	80	4.76
6	168.3	146.36	10.97	189	80	7.71
8	219.1	193.70	12.70	252	80	15.56
10	273.0	247.60	12.70	316	60	24.27
12	323.8	298.40	12.70	378	*	35.20
14	355.6	330.20	12.70	441	*	45.36
16	406.4	381.00	12.70	505	40	60.78
18	457.0	431.60	12.70	568	*	77.11
20	508.0	482.60	12.70	632	30	94.80
24	610.0	584.60	12.70	757	*	136.98

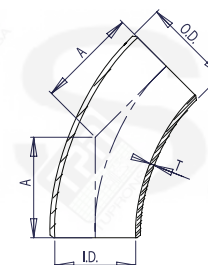

CODOS DE 45°

3R CÉDULA 40

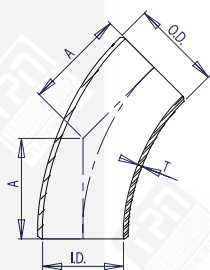

Tamaño del tubo	Diámetro exterior	Diámetro interior	Espesor de la pared	Centro a extremo	Nro. de cédula del tubo	Peso aprox. en kilogramos
NPS	O.D.	I.D.	T	A		
3/4	26.7	20.96	2.87	24	40	0.23
1	33.4	26.64	3.38	31	40	0.32
1 1/4	42.2	35.08	3.56	39	40	0.45
1 1/2	48.3	40.94	3.68	47	40	0.59
2	60.3	52.48	3.91	63	40	0.68
2 1/2	73.0	62.68	5.16	79	40	0.79
3	88.9	77.92	5.49	95	40	1.36
3 1/2	101.6	90.12	5.74	111	40	2.27
4	114.3	102.26	6.02	127	40	4.08
5	141.3	128.20	6.55	157	40	7.26
6	168.3	154.08	7.11	189	40	10.21
8	219.1	202.74	8.18	252	40	20.41
10	273.0	254.46	9.27	316	40	36.29
12	323.8	303.18	10.31	378	40	72.57
14	355.6	333.34	11.13	441	40	122.47
16	406.4	381.00	12.70	505	40	163.29
18	457.0	428.46	14.27	568	40	222.26
20	508.0	477.82	15.09	632	40	278.96
24	610.0	575.04	17.48	757	40	351.53

3R CÉDULA 80

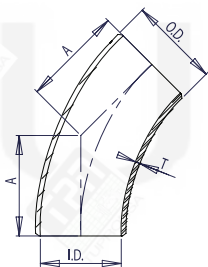

Tamaño del tubo	Diámetro exterior	Diámetro interior	Espesor de la pared	Centro a extremo	Nro. de cédula del tubo	Peso aprox. en kilogramos
NPS	O.D.	I.D.	T	A		
3/4	26.7	18.88	3.91	24	80	0.07
1	33.4	24.30	4.55	31	80	0.13
1 1/4	42.2	32.50	4.85	39	80	0.20
1 1/2	48.3	38.14	5.08	47	80	0.28
2	60.3	49.22	5.54	63	80	0.54
2 1/2	73.0	58.98	7.01	79	80	0.91
3	88.9	73.66	7.62	95	80	1.50
3 1/2	101.6	85.44	8.08	111	80	2.04
4	114.3	97.18	8.56	127	80	2.81
5	141.3	122.24	9.53	157	80	4.76
6	168.3	146.36	10.97	189	80	7.71
8	219.1	193.70	12.70	252	80	15.56
10	273.0	242.82	15.09	316	80	68.04
12	323.8	288.84	17.48	378	80	90.72
14	355.6	317.50	19.05	441	80	153.09
16	406.4	363.52	21.44	505	80	204.12
18	457.0	409.34	23.83	568	80	277.82
20	508.0	455.62	26.19	632	80	348.70
24	610.0	548.08	30.96	757	80	439.42

CODOS DE RETORNO DE 180°

RADIO LARGO CÉDULA STD

Tamaño del tubo	Diámetro exterior	Diámetro interior	Espesor de la pared	Centro a centro	Parte posterior a parte delantera	Nro. de cédula del tubo	Peso aprox. en kilogramos
NPS	O.D.	I.D.	T	V	W		
1/2	21.3	15.76	2.77	76	48	40	0.15
3/4	26.7	20.96	2.87	76	51	40	0.15
1	33.4	26.64	3.38	76	56	40	0.34
1 1/4	42.2	35.08	3.56	95	70	40	0.50
1 1/2	48.3	40.94	3.68	114	83	40	0.73
2	60.3	52.48	3.91	152	106	40	1.45
2 1/2	73.0	62.68	5.16	190	132	40	2.77
3	88.9	77.92	5.49	229	159	40	4.26
3 1/2	101.6	90.12	5.74	267	184	40	5.81
4	114.3	102.26	6.02	305	210	40	7.94
5	141.3	128.20	6.55	381	262	40	13.29
6	168.3	154.08	7.11	457	313	40	21.32
8	219.1	202.74	8.18	610	414	40	39.46
10	273.0	254.46	9.27	762	518	40	74.39
12	323.8	304.74	9.53	914	619	*	107.50
14	355.6	336.54	9.53	1067	711	30	141.07
16	406.4	387.34	9.53	1219	813	30	185.06
18	457.0	437.94	9.53	1372	914	*	233.15
20	508.0	488.94	9.53	1524	1016	20	288.48
24	610.0	590.94	9.53	1829	1219	20	411.86

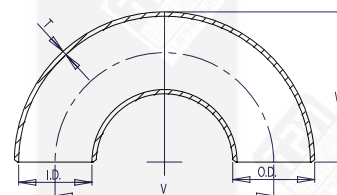

RADIO LARGO CÉDULA XS

Tamaño del tubo	Diámetro exterior	Diámetro interior	Espesor de la pared	Centro a centro	Parte posterior a parte delantera	Nro. de cédula del tubo	Peso aprox. en kilogramos
NPS	O.D.	I.D.	T	V	W		
1/2	21.3	13.84	3.73	76	48	80	0.20
3/4	26.7	18.88	3.91	76	51	80	0.24
1	33.4	24.30	4.55	76	56	80	0.44
1 1/4	42.2	32.50	4.85	95	70	80	0.73
1 1/2	48.3	38.14	5.08	114	83	80	1.00
2	60.3	49.22	5.54	152	106	80	1.86
2 1/2	73.0	58.98	7.01	190	132	80	3.49
3	88.9	73.66	7.62	229	159	80	5.62
3 1/2	101.6	85.44	8.08	267	184	80	7.76
4	114.3	97.18	8.56	305	210	80	10.93
5	141.3	122.24	9.53	381	262	80	18.91
6	168.3	146.36	10.97	457	313	80	30.93
8	219.1	193.70	12.70	610	414	60	63.50
10	273.0	247.60	12.70	762	518	*	98.43
12	323.8	298.40	12.70	914	619	*	141.07
14	355.6	330.20	12.70	1067	711	40	181.44
16	406.4	381.00	12.70	1219	813	*	244.94
18	457.0	431.60	12.70	1372	914	30	311.16
20	508.0	482.60	12.70	1524	1016	*	381.02
24	610.0	584.60	12.70	1829	1219	*	548.84

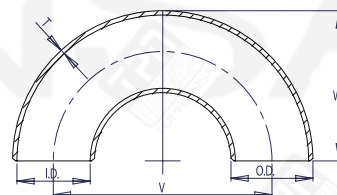

CODOS DE RETORNO DE 180°

RADIO LARGO CÉDULA 40

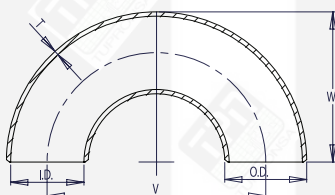

Tamaño del tubo	Diámetro exterior	Diámetro interior	Espesor de la pared	Centro a centro	Parte posterior a parte delantera	Nro. de cédula del tubo	Peso aprox. en kilogramos
NPS	O.D.	I.D.	T	V	W		
½	21.3	15.76	2.77	76	48	40	0.15
¾	26.7	20.96	2.87	76	51	40	0.15
1	33.4	26.64	3.38	76	56	40	0.34
1 ¼	42.2	35.08	3.56	95	70	40	0.50
1 ½	48.3	40.94	3.68	114	83	40	0.73
2	60.3	52.48	3.91	152	106	40	1.45
2 ½	73.0	62.68	5.16	190	132	40	2.77
3	88.9	77.92	5.49	229	159	40	4.26
3 ½	101.6	90.12	5.74	267	184	40	5.81
4	114.3	102.26	6.02	305	210	40	7.94
5	141.3	128.20	6.55	381	262	40	13.29
6	168.3	154.08	7.11	457	313	40	21.32
8	219.1	202.74	8.18	610	414	40	39.46
10	273.0	254.46	9.27	762	518	40	74.39
12	323.8	303.18	10.31	914	619	40	108.86
14	355.6	333.34	11.13	1067	711	40	142.88
16	406.4	381.00	12.70	1219	813	40	185.97
18	457.0	428.46	14.27	1372	914	40	235.87
20	508.0	477.82	15.09	1524	1016	40	290.30
24	610.0	575.04	17.48	1829	1219	40	415.03

RADIO LARGO CÉDULA 80

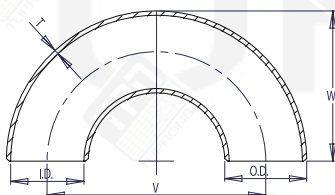

Tamaño del tubo	Diámetro exterior	Diámetro interior	Espesor de la pared	Centro a centro	Parte posterior a parte delantera	Nro. de cédula del tubo	Peso aprox. en kilogramos
NPS	O.D.	I.D.	T	V	W		
½	21.3	13.84	3.73	76	48	80	0.20
¾	26.7	18.88	3.91	76	51	80	0.24
1	33.4	24.30	4.55	76	56	80	0.44
1 ¼	42.2	32.50	4.85	95	70	80	0.73
1 ½	48.3	38.14	5.08	114	83	80	1.00
2	60.3	49.22	5.54	152	106	80	1.86
2 ½	73.0	58.98	7.01	190	132	80	3.49
3	88.9	73.66	7.62	229	159	80	5.62
3 ½	101.6	85.44	8.08	267	184	80	7.76
4	114.3	97.18	8.56	305	210	80	10.93
5	141.3	122.24	9.53	381	262	80	18.91
6	168.3	146.36	10.97	457	313	80	30.93
8	219.1	193.70	12.70	610	414	80	63.50
10	273.0	242.82	15.09	762	518	80	99.79
12	323.8	288.84	17.48	914	619	80	142.88
14	355.6	317.50	19.05	1067	711	80	185.97
16	406.4	363.52	21.44	1219	813	80	249.47
18	457.0	409.34	23.83	1372	914	80	315.25
20	508.0	455.62	26.19	1524	1016	80	385.55
24	610.0	548.08	30.96	1829	1219	80	555.65

CODOS DE RETORNO DE 180°

Tamaño del tubo	Diámetro exterior	Diámetro interior	Espesor de la pared	Centro a centro	Parte posterior a parte delantera	Nro. de cédula del tubo	Peso aprox. en kilogramos
NPS	O.D.	I.D.	T	V	W		
1/2	21.3	11.74	4.78	76	48	160	0.18
3/4	26.7	15.58	5.56	76	51	160	0.20
1	33.4	20.70	6.35	76	56	160	0.42
1 1/4	42.2	29.50	6.35	95	70	160	0.63
1 1/2	48.3	34.02	7.14	114	83	160	0.91
2	60.3	42.82	8.74	152	106	160	1.81
2 1/2	73.0	53.94	9.53	190	132	160	3.46
3	88.9	66.64	11.13	229	159	160	5.33
4	114.3	87.32	13.49	305	210	160	9.92
5	141.3	109.54	15.88	381	262	160	16.62
6	168.3	131.78	18.26	457	313	160	26.65
8	219.1	173.08	23.01	610	414	160	49.33
10	273.0	215.84	28.58	762	518	160	92.99
12	323.8	257.16	33.32	914	619	160	134.38
14	355.6	284.18	35.71	1067	711	160	176.33
16	406.4	325.42	40.49	1219	813	160	231.33
18	457.0	366.52	45.24	1372	914	160	291.43
20	508.0	407.98	50.01	1524	1016	160	360.60
24	610.0	490.92	59.54	1829	1219	160	514.82

RADIO LARGO CÉDULA 160

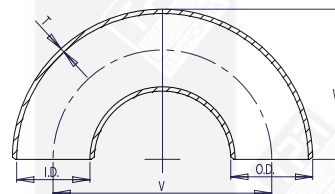

Tamaño del tubo	Diámetro exterior	Diámetro interior	Espesor de la pared	Centro a centro	Parte posterior a parte delantera	Nro. de cédula del tubo	Peso aprox. en kilogramos
NPS	O.D.	I.D.	T	V	W		
1/2	21.3	6.36	7.47	76	48	*	0.20
3/4	26.7	11.06	7.82	76	51	*	0.21
1	33.4	15.22	9.09	76	56	*	0.46
1 1/4	42.2	22.80	9.70	95	70	*	0.68
1 1/2	48.3	28.00	10.15	114	83	*	1.00
2	60.3	38.16	11.07	152	106	*	2.00
2 1/2	73.0	44.96	14.02	190	132	*	3.81
3	88.9	58.42	15.24	229	159	*	5.86
4	114.3	80.06	17.12	305	210	*	10.91
5	141.3	103.20	19.05	381	262	*	18.28
6	168.3	124.40	21.95	457	313	*	29.32
8	219.1	174.64	22.23	610	414	*	54.26
10	273.0	222.20	25.40	762	518	140	102.28
12	323.8	273.00	25.40	914	619	120	147.82

RADIO LARGO CÉDULA XXS

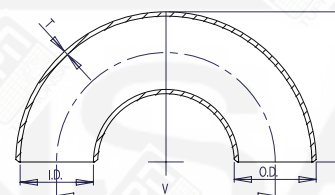

CODOS DE RETORNO DE 180°

RADIO CORTO CÉDULA STD

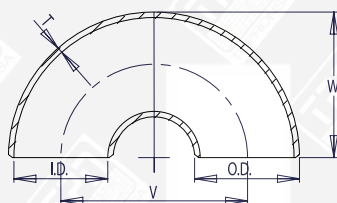

Tamaño del tubo	Diámetro exterior	Diámetro interior	Espesor de la pared	Centro a centro	Parte posterior a parte delantera	Nro. de cédula del tubo	Peso aprox. en kilogramos
NPS	O.D.	I.D.	T	V	W		
1	33.4	26.64	3.38	51	41	40	0.23
1 ¼	42.2	35.08	3.56	64	52	40	0.36
1 ½	48.3	40.94	3.68	76	62	40	0.50
2	60.3	52.48	3.91	102	81	40	0.86
2 ½	73.0	62.68	5.16	127	100	40	1.81
3	88.9	77.92	5.49	152	121	40	2.72
3 ½	101.6	90.12	5.74	178	140	40	3.95
4	114.3	102.26	6.02	203	159	40	5.53
5	141.3	128.20	6.55	254	197	40	8.71
6	168.3	154.08	7.11	305	237	40	14.92
8	219.1	202.74	8.18	406	313	40	29.44
10	273.0	254.46	9.27	508	391	40	50.80
12	323.8	304.74	9.53	610	467	*	71.21
14	355.6	336.54	9.53	711	533	30	94.35
16	406.4	387.34	9.53	813	610	30	116.57
18	457.0	437.94	9.53	914	686	*	147.42
20	508.0	488.94	9.53	1016	762	20	188.69
24	610.0	590.94	9.53	1219	914	20	268.53

RADIO CORTO CÉDULA XS

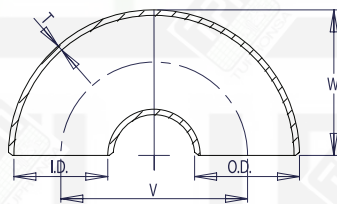

Tamaño del tubo	Diámetro exterior	Diámetro interior	Espesor de la pared	Centro a centro	Parte posterior a parte delantera	Nro. de cédula del tubo	Peso aprox. en kilogramos
NPS	O.D.	I.D.	T	V	W		
1	33.4	24.30	4.55	51	41	80	0.32
1 ¼	42.2	32.50	4.85	64	52	80	0.45
1 ½	48.3	38.14	5.08	76	62	80	0.68
2	60.3	49.22	5.54	102	81	80	1.32
2 ½	73.0	58.98	7.01	127	100	80	2.36
3	88.9	73.66	7.62	152	121	80	3.72
3 ½	101.6	85.44	8.08	178	140	80	5.31
4	114.3	97.18	8.56	203	159	80	7.44
5	141.3	122.24	9.53	254	197	80	12.56
6	168.3	146.36	10.97	305	237	80	20.73
8	219.1	193.70	12.70	406	313	80	43.68
10	273.0	247.60	12.70	508	391	60	64.86
12	323.8	298.40	12.70	610	467	*	96.16
14	355.6	330.20	12.70	711	533	*	122.92
16	406.4	381.00	12.70	813	610	40	153.77
18	457.0	431.60	12.70	914	686	*	192.78
20	508.0	482.60	12.70	1016	762	30	251.74
24	610.0	584.60	12.70	1219	914	*	352.89

CODOS DE RETORNO DE 180°

RADIO CORTO CÉDULA 40

Tamaño del tubo	Diámetro exterior	Diámetro interior	Espesor de la pared	Centro a centro	Parte posterior a parte delantera	Nro. de cédula del tubo	Peso aprox. en kilogramos
NPS	O.D.	I.D.	T	V	W		
1	33.4	26.64	3.38	51	41	40	0.23
1 ¼	42.2	35.08	3.56	64	52	40	0.36
1 ½	48.3	40.94	3.68	76	62	40	0.50
2	60.3	52.48	3.91	102	81	40	0.86
2 ½	73.0	62.68	5.16	127	100	40	1.81
3	88.9	77.92	5.49	152	121	40	2.72
3 ½	101.6	90.12	5.74	178	140	40	3.95
4	114.3	102.26	6.02	203	159	40	5.53
5	141.3	128.20	6.55	254	197	40	8.71
6	168.3	154.08	7.11	305	237	40	14.92
8	219.1	202.74	8.18	406	313	40	29.44
10	273.0	254.46	9.27	508	391	40	50.80
12	323.8	303.18	10.31	610	467	40	74.84
14	355.6	333.34	11.13	711	533	40	97.52
16	406.4	381.00	12.70	813	610	40	120.20
18	457.0	428.46	14.27	914	686	40	151.95
20	508.0	477.82	15.09	1016	762	40	192.78
24	610.0	575.04	17.48	1219	914	40	274.42

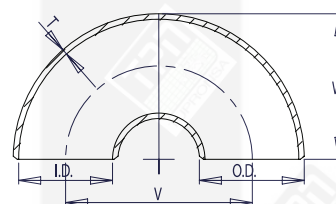

RADIO CORTO CÉDULA 80

Tamaño del tubo	Diámetro exterior	Diámetro interior	Espesor de la pared	Centro a centro	Parte posterior a parte delantera	Nro. de cédula del tubo	Peso aprox. en kilogramos
NPS	O.D.	I.D.	T	V	W		
1	33.4	24.30	4.55	51	41	80	0.32
1 ¼	42.2	32.50	4.85	64	52	80	0.45
1 ½	48.3	38.14	5.08	76	62	80	0.68
2	60.3	49.22	5.54	102	81	80	1.32
2 ½	73.0	58.98	7.01	127	100	80	2.36
3	88.9	73.66	7.62	152	121	80	3.72
3 ½	101.6	85.44	8.08	178	140	80	5.31
4	114.3	97.18	8.56	203	159	80	7.44
5	141.3	122.24	9.53	254	197	80	12.56
6	168.3	146.36	10.97	305	237	80	20.73
8	219.1	193.70	12.70	406	313	80	43.68
10	273.0	242.82	15.09	508	391	80	72.57
12	323.8	288.84	17.48	610	467	80	102.06
14	355.6	317.50	19.05	711	533	80	127.01
16	406.4	363.52	21.44	813	610	80	158.76
18	457.0	409.34	23.83	914	686	80	197.31
20	508.0	455.62	26.19	1016	762	80	258.55
24	610.0	548.08	30.96	1219	914	80	358.34

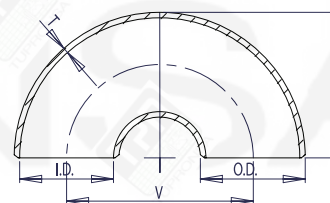

CODOS DE RETORNO DE 180°

RADIO CORTO CÉDULA 160

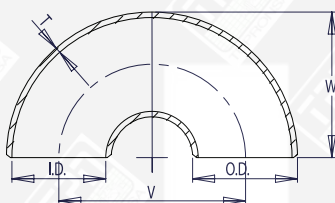

Tamaño del tubo	Diámetro exterior	Diámetro interior	Espesor de la pared	Centro a centro	Parte posterior a parte delantera	Nro. de cédula del tubo	Peso aprox. en kilogramos
NPS	O.D.	I.D.	T	V	W		
1	33.4	20.70	6.35	51	41	160	0.39
1 ¼	42.2	29.50	6.35	64	52	160	0.55
1 ½	48.3	34.02	7.14	76	62	160	0.83
2	60.3	42.82	8.74	102	81	160	1.59
2 ½	73.0	53.94	9.53	127	100	160	2.85
3	88.9	66.64	11.13	152	121	160	4.50
4	114.3	87.32	13.49	203	159	160	9.00
5	141.3	109.54	15.88	254	197	160	15.20
6	168.3	131.78	18.26	305	237	160	25.08
8	219.1	173.08	23.01	406	313	160	52.85
10	273.0	215.84	28.58	508	391	160	78.48
12	323.8	257.16	33.32	610	467	160	116.35
14	355.6	284.18	35.71	711	533	160	148.74
16	406.4	325.42	40.49	813	610	160	186.06
18	457.0	366.52	45.24	914	686	160	233.26
20	508.0	407.98	50.01	1016	762	160	304.61
24	610.0	490.92	59.54	1219	914	160	427.00

RADIO CORTO CÉDULA XXS

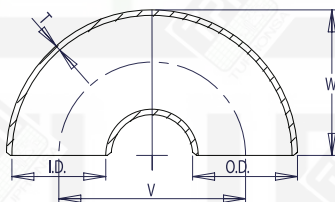

Tamaño del tubo	Diámetro exterior	Diámetro interior	Espesor de la pared	Centro a centro	Parte posterior a parte delantera	Nro. de cédula del tubo	Peso aprox. en kilogramos
NPS	O.D.	I.D.	T	V	W		
1	33.4	15.22	9.09	51	41	*	0.42
1 ¼	42.2	22.80	9.70	64	52	*	0.60
1 ½	48.3	28.00	10.15	76	62	*	0.91
2	60.3	38.16	11.07	102	81	*	1.77
2 ½	73.0	44.96	14.02	127	100	*	3.14
3	88.9	58.42	15.24	152	121	*	4.95
4	114.3	80.06	17.12	203	159	*	9.90
5	141.3	103.20	19.05	254	197	*	16.72
6	168.3	124.40	21.95	305	237	*	27.59
8	219.1	174.64	22.23	406	313	*	58.14
10	273.0	222.20	25.40	508	391	140	86.33
12	323.8	273.00	25.40	610	467	120	127.99